

## Marylebone, NW1

**£560 per week** Fees May Apply

A wonderful two double bedroom flat offering large living space and separate dining area. This second floor flat is located in a well maintained building just opposite Marylebone Tube Station and close to a wealth of shops and amenities on Gloucester Place and Baker Street. The property has been recently redecorated and has brand new carpets. It comprises a reception room, dining area, kitchen with fitted appliances, master bedroom, double bedroom and a bathroom. There are two tube stations within walking distance apart from Marylebone Station - Baker Street (Circle, Bakerloo, Jubilee, Metropolitan, Hammersmith & City) and Edgware Road.

**2 Bedrooms | 1 Reception Room | 1 Bathroom  
Furnished**

### Notting Hill Office

27 Kensington Park Road, London W11 2EU

020 7221 2277

[lettings.nhg@mountgrangeheritage.co.uk](mailto:lettings.nhg@mountgrangeheritage.co.uk)

**Other offices** Kensington - North Kensington

[mountgrangeheritage.co.uk](http://mountgrangeheritage.co.uk)

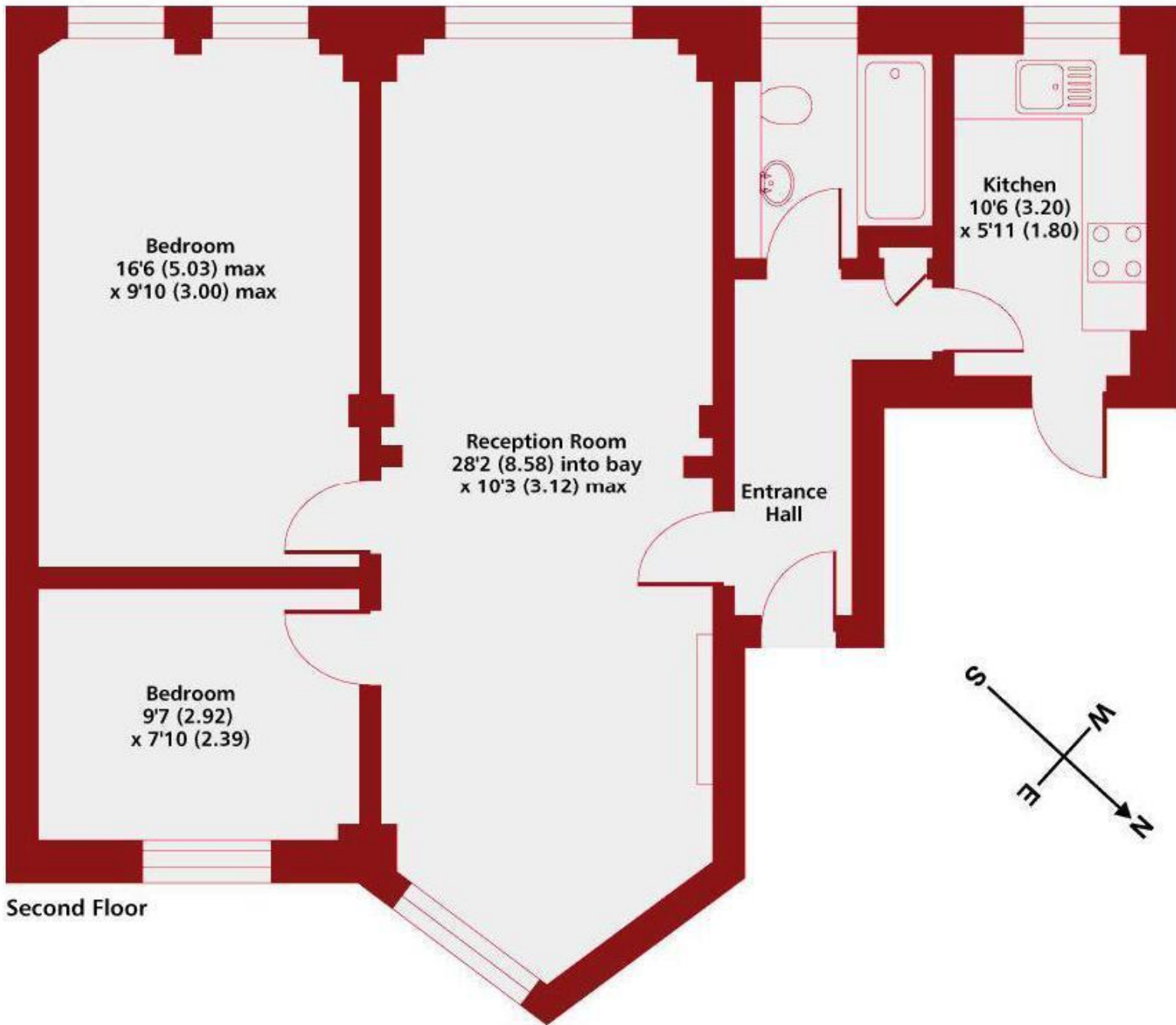

**Regis Court NW1**  
**Gross Internal Area 714 sq ft 66.3sq metres**

**IMPORTANT NOTICE**

Mountgrange Heritage and their clients give notice that: 1) They are not authorised to make or give any representations or warranties in relation to the property either here or elsewhere, either on their own behalf or on behalf of their client or otherwise. They assume no responsibility for any statement that may be made in these particulars. These particulars do not form part of any offer or contract and must not be relied upon as statements or representations of fact. 2) Any areas, measurements or distances are approximate. The text, photographs and plans are for guidance only and are not necessarily comprehensive. It should not be assumed that the property has all necessary planning, building regulation or other consents and Mountgrange Heritage have not tested any services, equipment or facilities. Purchasers must satisfy themselves by inspection or otherwise.